

4 Drawer Configuration

3 x 1.5" Tall Drawers

1 x 3.5" Tall Drawer

Approximately 38" Total Open Space

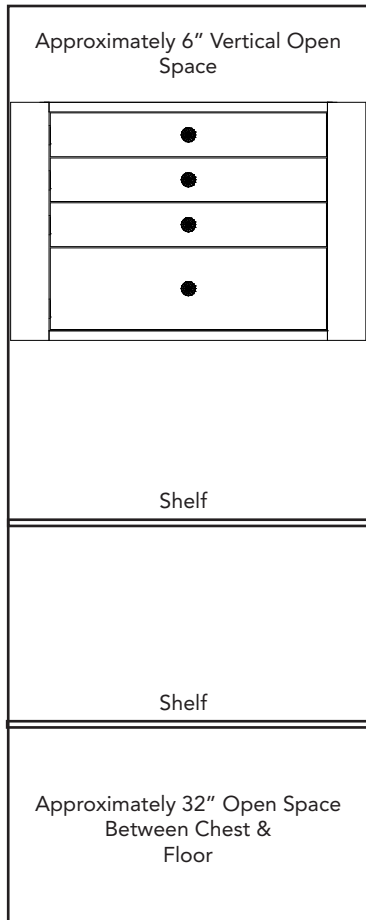

7 Drawer Configuration

6 x 1.5" Tall Drawers

1 x 3.5" Tall Drawer

Approximately 31" Total Open Space

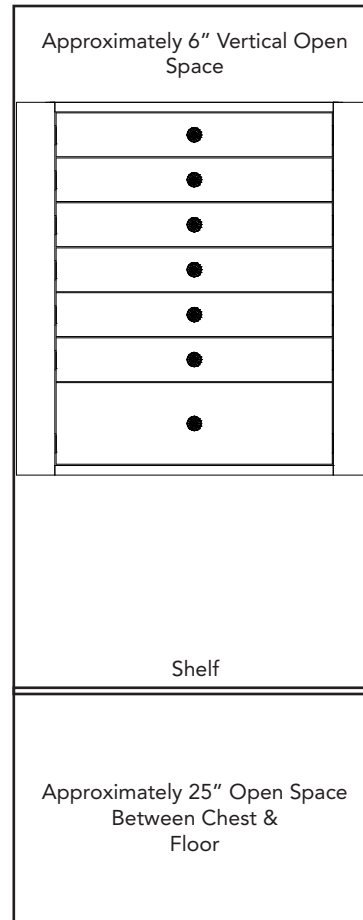

11 Drawer Configuration

8 x 1.5" Tall Drawers

3 x 3.5" Tall Drawer

Approximately 18" Total Open Space

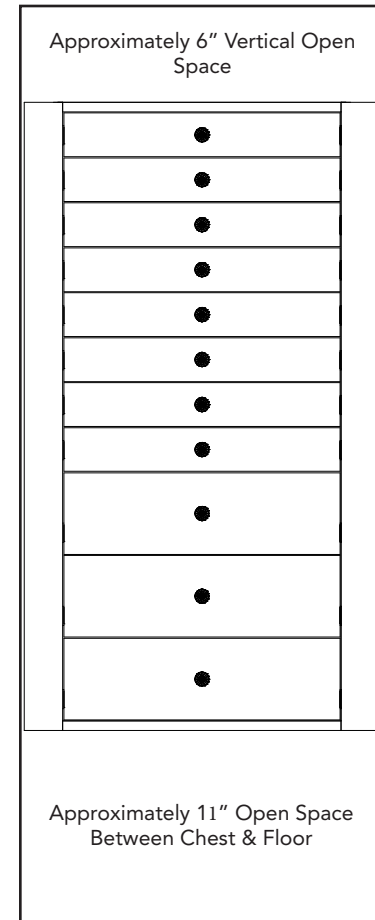

Not to Scale. Drawers can be placed higher or lower in the safe according to your preference. Custom configurations with different numbers and heights of drawers are available.

4 Drawer Configuration

3 x 1.5" Tall Drawers

1 x 3.5" Tall Drawer

Approximately 45" Total Open Space

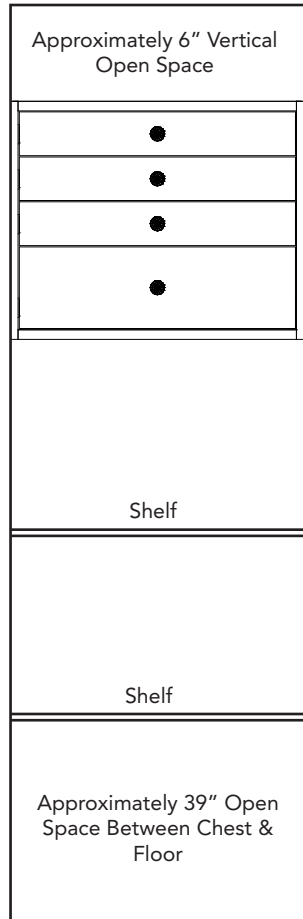

7 Drawer Configuration

6 x 1.5" Tall Drawers

1 x 3.5" Tall Drawer

Approximately 38" Total Open Space

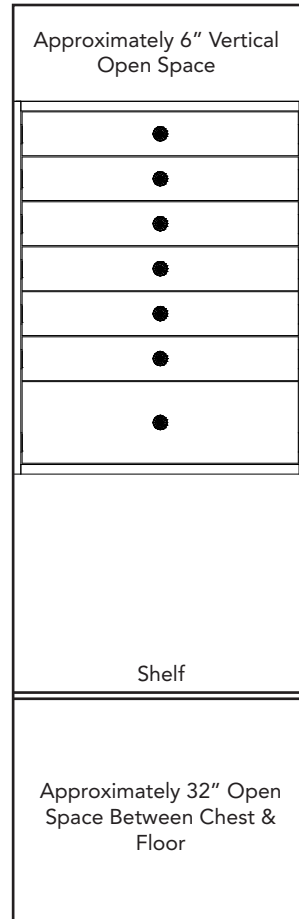

11 Drawer Configuration

8 x 1.5" Tall Drawers

3 x 3.5" Tall Drawer

Approximately 25" Total Open Space

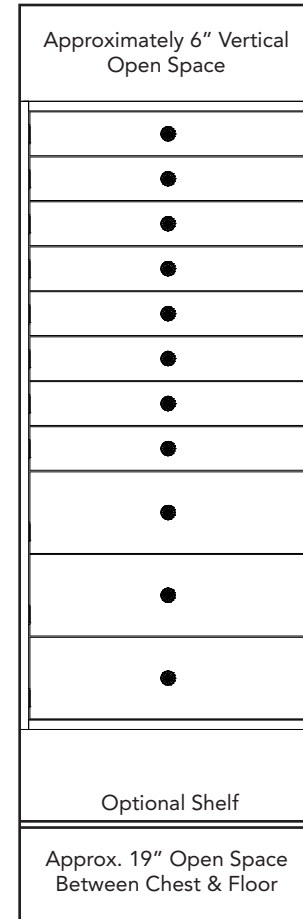

Not to Scale. Drawers can be placed higher or lower in the safe according to your preference. Placement of drawers on the floor of the safe prohibit access to predrilled holes for bolt down. Custom configurations with different numbers and heights of drawers are available.

4 Drawer Configuration

3 x 1.5" Tall Drawers

1 x 3.5" Tall Drawer

Approximately 45" Total Open Space

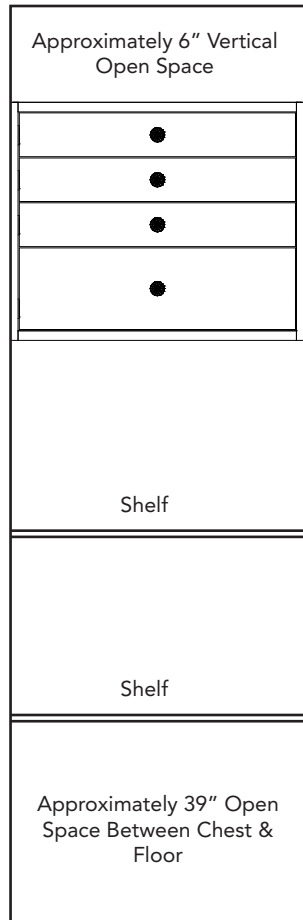

7 Drawer Configuration

6 x 1.5" Tall Drawers

1 x 3.5" Tall Drawer

Approximately 38" Total Open Space

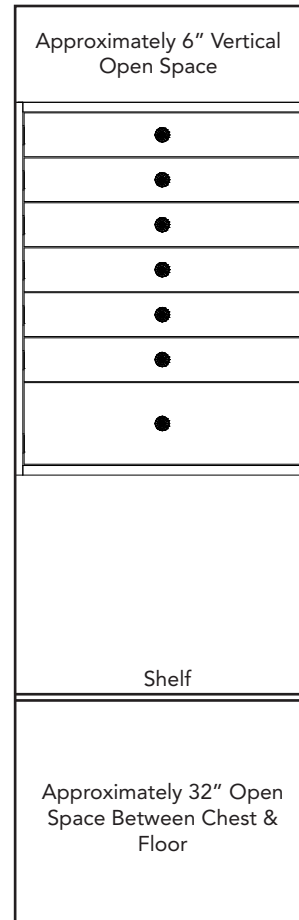

11 Drawer Configuration

8 x 1.5" Tall Drawers

3 x 3.5" Tall Drawer

Approximately 25" Total Open Space

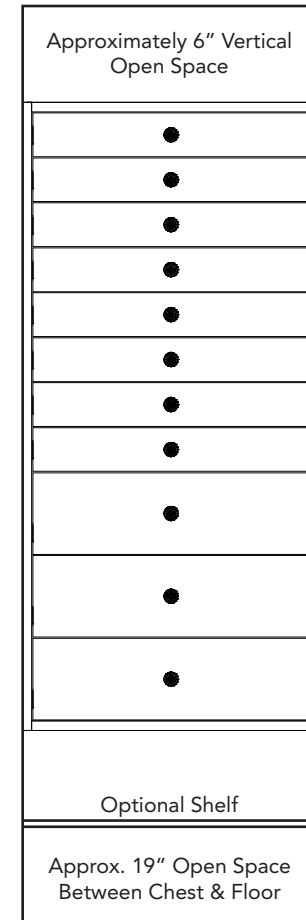

Not to Scale. Drawers can be placed higher or lower in the safe according to your preference. Custom configurations with different numbers and heights of drawers are available.